

# VIRASHA

## HEIGHTS

LIFE COMES ALIVE.

4BHK Premium Duplexes

*Experience living like never before,*



### ACTUAL PHOTOGRAPHS



### AMENITIES

Modern Club House | Swimming Pool | Indoor Games | Party Hall | Landscaped Garden  
Children's Play Area | 24x7 Secured Campus with Centralize Surveillance  
Power Back-up in Common Areas

*A lifestyle that's nowhere but somewhere in your thoughts*



*Look Forward To A Wonderful Life*

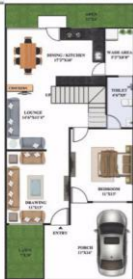

GROUND FLOOR PLAN

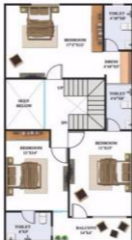

FIRST FLOOR PLAN

## SPECIFICATIONS

- **Structure:** Earthquake resistant, R.C.C. framed structure with superior quality Brick work with Plaster finish.
- **Flooring and Wall Tiling:** Vitrified tiles size 2'x2' and modern designer tile concept in bathrooms.
- **Doors and Windows:** Flush doors with wooden frame and safety locks, Superior quality S.S. finish hardware fittings, Powder coated 3 track Aluminum Windows.
- **Electrical Work:** 3-phase concealed and fire resistant electrical work.
- **Painting :** Long Lasting and weather resistant paint.
- **Plumbing & Sanitation :** Good quality Designer sanitary ware for spotless and sparkling toilets
- **Kitchen:** Granite platform and ceramic tiles dado.

Site :- E-8 Ext., Near Bawadiakola Bridge,  
Bhopal - 462042 (M.P.)

### BEYOND THE SALE

1<sup>ST</sup> PHASE POSSESSION DELIVERED,  
2<sup>ND</sup> PHASE CONSTRUCTION IN FULL SWING.

**VIRASHA**  
HEIGHTS  
LIFE COMES ALIVE.



Kolar Castle, Chumbhatti Square, Bhopal-16  
Contact - 082238-44424, 096690-02904,  
096694-49295  
Email - virasha\_infrastructure@gmail.com  
manager.marketing@virasha.com



architect, engineers and interior designers

AR, VIPIN CHASHAN  
Kolar Castle, Chumbhatti Square, Bhopal-16  
P 0755-4266719, 98243-86671  
E: dimensions\_bpl@yahoo.co.in

